



Westinghouse

INNOVATION YOU CAN BE SURE OF

RTS Installation Quick Guide

STEP 1: DOOR TEMPLATE

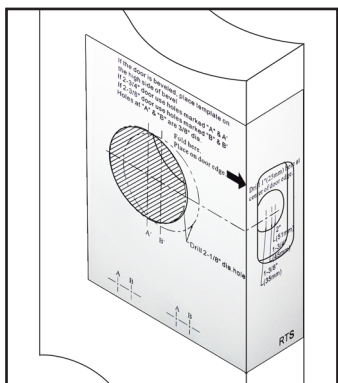

1. Fold the template and ensure it is square to the door.
2. Choose A or B holes to line up with your existing backset.

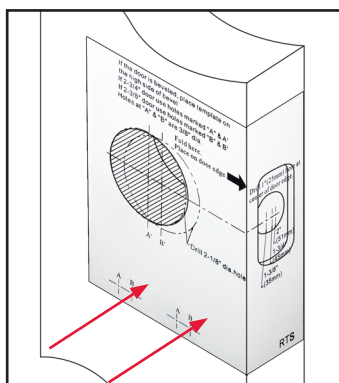

3. Bore two 3/8" holes through the door at either A or B depending on the backset.

STEP 2: LATCH

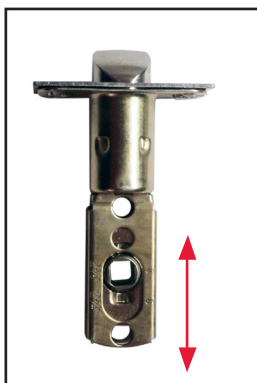

1. Adjust the backset by sliding the spindle hole to the correct setting for your door.



2. Using the parts in Bag A, insert the latch into the hole in the edge of the door and screw into place.
3. Mount the strike or use existing strike frame.

STEP 3: UNIT HANDLES



1. Using the screws from Bag B, install the handles onto the inside unit and outside unit based on your right/left handed configuration.
2. Tighten the handle screw with a screwdriver, so the handle is firmly held in place.

STEP 4: MOUNTING OUTSIDE UNIT



Outside gasket for Step 4



Outside unit for Step 4

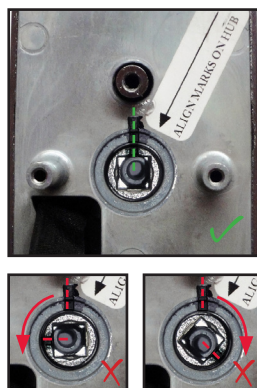

1. Align the marks on the hub as shown in top image.



2. Attach the outside rubber gasket to the back of the outdoor unit.

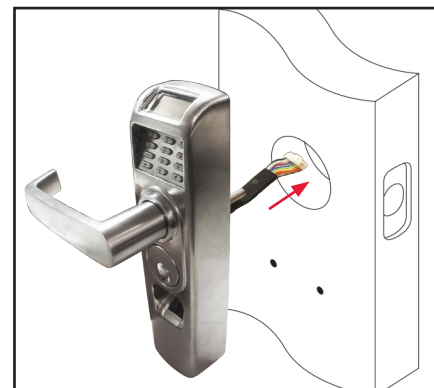

3. Feed the outside unit cable underneath the latch and align the fixing posts with the two corresponding holes in the latch.

STEP 5: FIXING PLATE

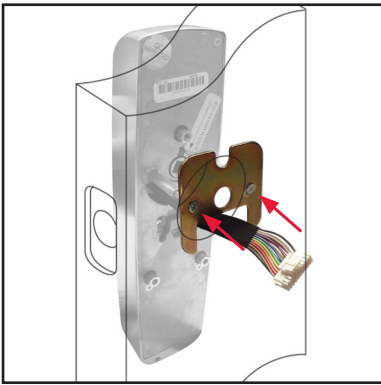

1. Using the 1 ½" screws in Bag C, screw the fixing plate onto the door until it is snug. DO NOT over tighten the screws.

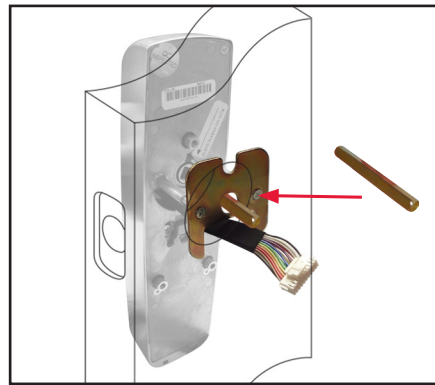

2. Insert the spindle thru the hole into the fixing plate until fully seated in the hub of the outside unit.

STEP 6: MOUNTING INSIDE UNIT (PART 1)



Inside unit for Step 6

Inside gasket for Step 6

1. Attach rubber gasket onto the inside unit.



2. Plug the cables from the outside unit into the inside unit. Be sure the cables are well seated

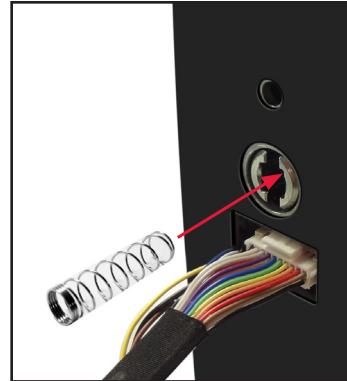

3. Insert spring from Bag D into inside unit's square hole.

4. Feed excess cable into the 2 1/8" hole.



5. Slide inside unit over spindle and place inside unit onto door.

STEP 7: MOUNTING INSIDE UNIT (PART 2)



1. Remove the battery cover from the inside unit.

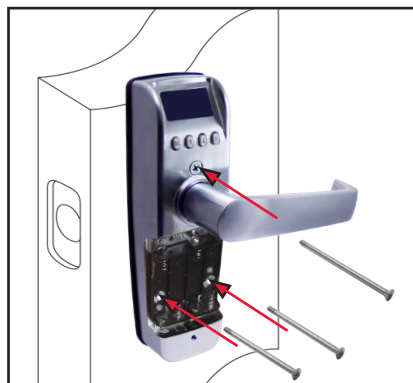

2. Using screws from Bag D, install inside unit onto door. The long screw is used for the top fixing post. The two shorter screws are used for the bottom fixing posts. Be careful not to pinch wires in the cable.

STEP 8: BATTERY INSTALLATION



1. Install 4 AA batteries (not included) as shown.



2. Reinstall the battery cover.